

WEST SUSSEX COUNTY COUNCIL
((CRAWLEY BOROUGH) (PARKING PLACES AND TRAFFIC REGULATION)
(CONSOLIDATION) ORDER 2010)
(BRUNEL PLACE AMENDMENT) ORDER 2015

CRAWLEY: LOCATION OF WAITING RESTRICTIONS

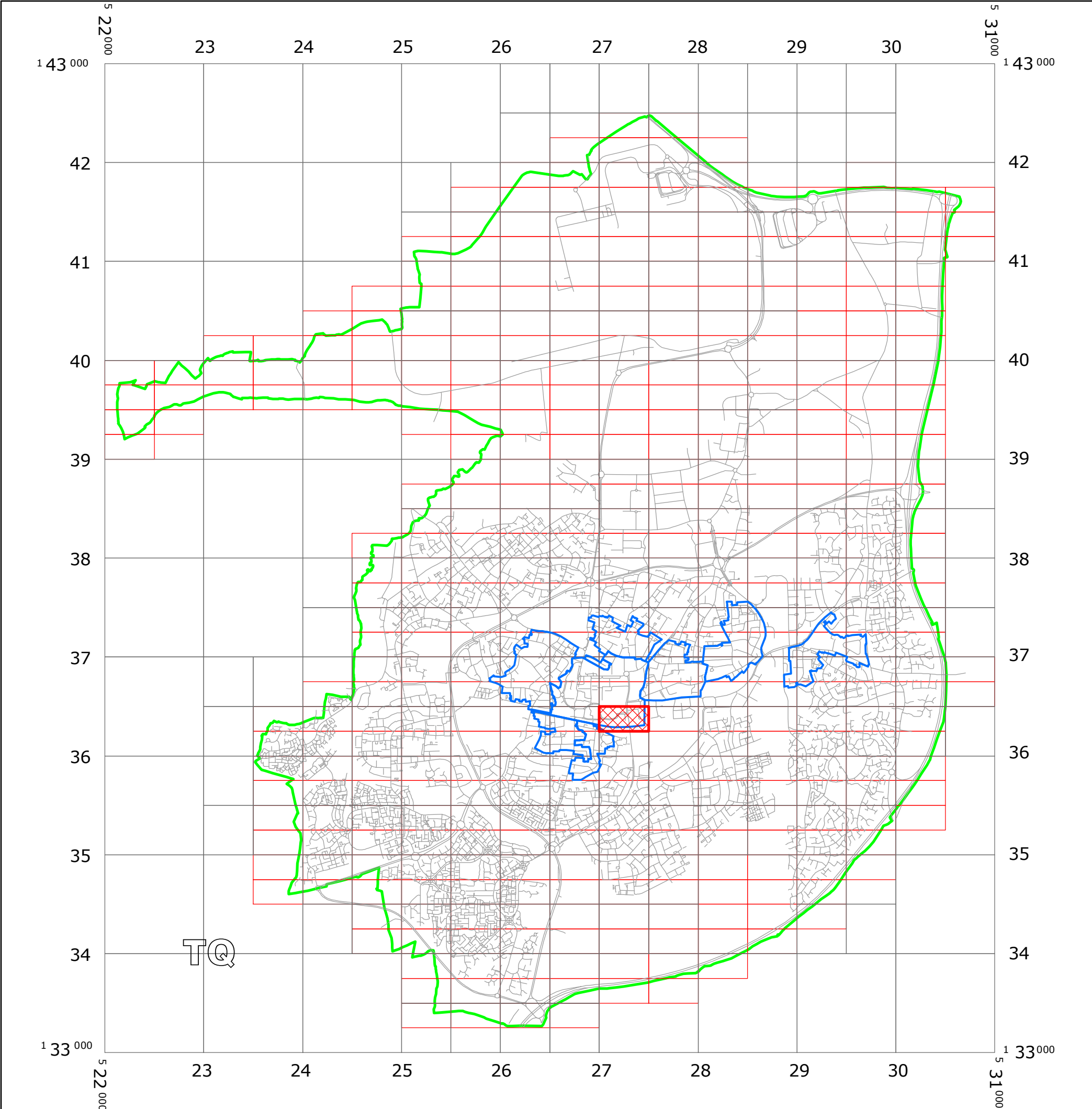

KEY:

OS TILE GRID

PARKING TILE GRID

LOCATION OF WAITING RESTRICTIONS

PARISH BOUNDARY

CONTROLLED PARKING ZONE BOUNDARY

ROAD NETWORK

Key for Waiting Restrictions

All areas over which the provision of the orders apply are defined by the shaded areas as shown on the following plans plus a contiguous area not indicated on the plans of verge and/or footway between the carriageway edge and the highway boundary. The plans in this schedule are based upon grid references of the Ordnance Survey National Grid defined by the OSGB 36 triangulation.

Prohibition of waiting at any time

100



z_circle

No waiting, loading and unloading at any time

101



check

No waiting at any time

Charged on-street parking

322

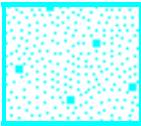

pat055

Pay and Display up to 3hrs 7.00am-6.00pm any day

Residents Parking

512

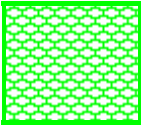

usgs503

Residents' and Visitors' permit holders only
9.00am-5.00pm Mon-Sat except bank holidays

527

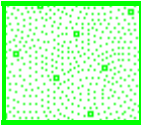

gravel

Permit holders only past this point
at any time

Specified Vehicles

854

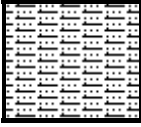

usgs617

No waiting at any time except taxis Midnight-3.00am



Boundary of Controlled Parking Zone

WEST SUSSEX COUNTY COUNCIL
((CRAWLEY BOROUGH) (PARKING PLACES AND TRAFFIC REGULATION)
(CONSOLIDATION) ORDER 2010)
(BRUNEL PLACE AMENDMENT) ORDER 2015

West Sussex County Council in exercise of their powers under Sections 1 (1) 2 (1) and (2), 4 (2), 45, 46, 49 and 53 and Part IV of Schedule 9 of the Road Traffic Regulation Act 1984 "the Act" as amended and of all other enabling powers and after consultation with the chief officer of police in accordance with Part III of Schedule 9 to the Act hereby make the following Order:-

1. This Order shall come into operation on the 21st day of September 2015 and may be cited as "West Sussex County Council ((Crawley Borough) (Parking Places and Traffic Regulation) (Consolidation) Order 2010) (Brunel Place Amendment) Order 2015."
2. The "West Sussex County Council (Crawley Borough) (Parking Places and Traffic Regulation) (Consolidation) Order 2010" is hereby amended by the deletion from it of the plan specified in the First Schedule to this Order and the substitution of the plan attached in the Second Schedule to this Order.

FIRST SCHEDULE
Plan to be deleted

TQ2736SWN (Sheet No. 2)

SECOND SCHEDULE
Plan to be substituted
(as attached)

TQ2736SWN (Sheet No. 3)

THE COMMON SEAL of WEST SUSSEX
COUNTY COUNCIL was hereto affixed

the Fifteenth day of September 2015
in the presence of:) (L.S)

Authorised Signatory

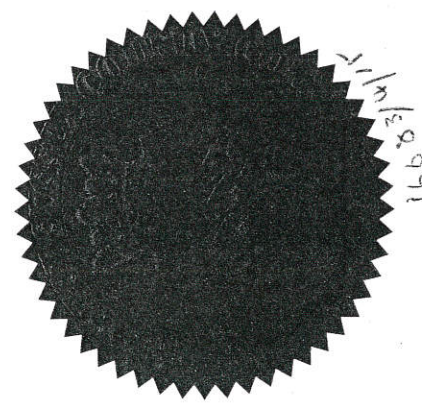

HEREBY CERTIFY THIS TO
BE A TRUE COPY OF THE
ORIGINAL DOCUMENT



Authorised Officer
WEST SUSSEX COUNTY COUNCIL

4/18 DELEGATED AUTHORITY

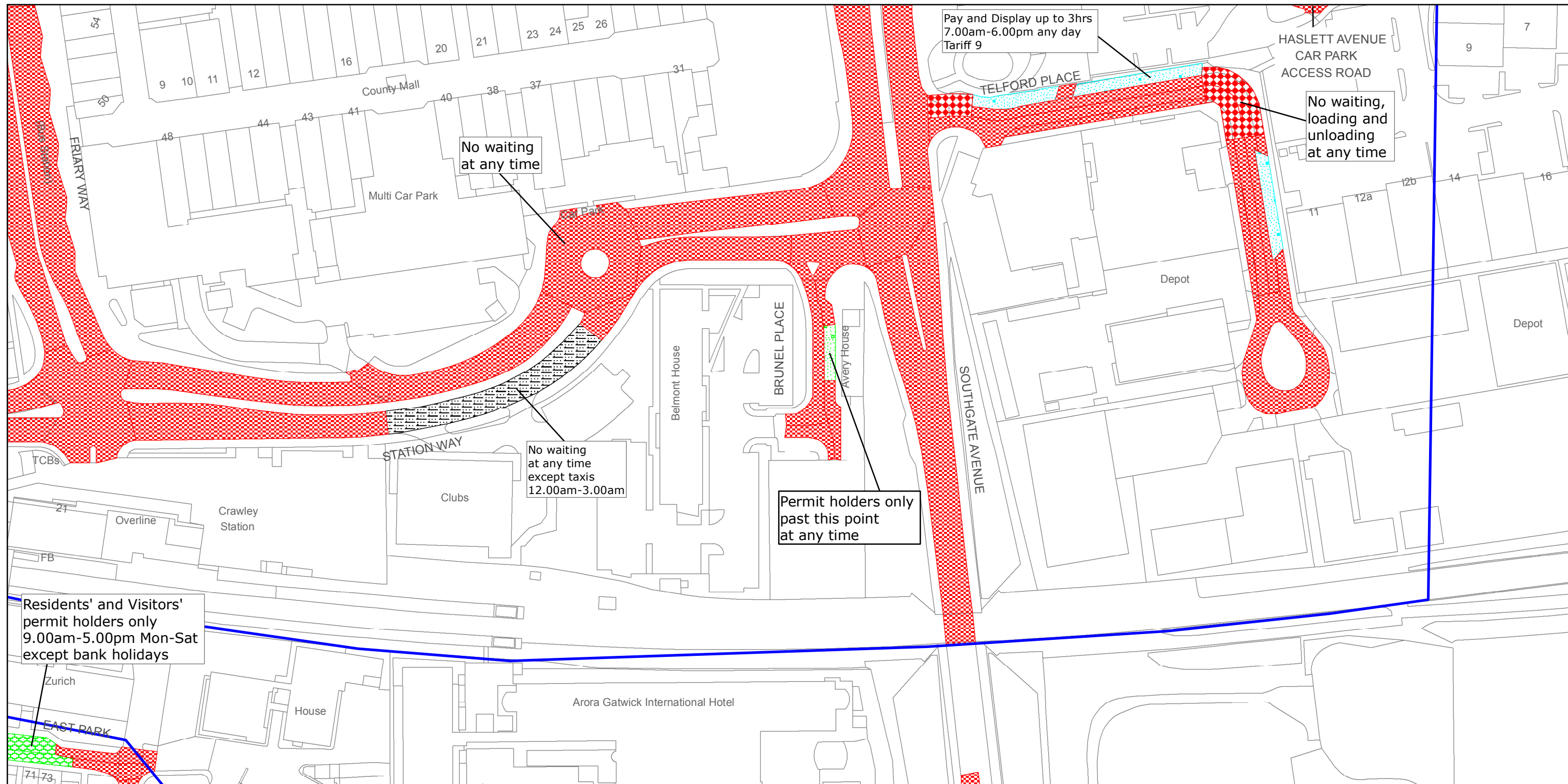

West Sussex County Council
Highways & Transport
The Grange
Tower Street
Chichester
West Sussex
PO19 1RH

CRAWLEY BOROUGH: FURNACE GREEN, NORTHGATE,
SOUTHGATE AND
THREE BRIDGES WARDS

WAITING RESTRICTIONS

TILE REF NO:
TQ2736SWN

SHEET ISSUE NO 3
SHEET ACTIVE FROM - 21/09/2015



SCALE:
1:1250
at A3 size

Reproduced from or based upon 2013 Ordnance Survey material with permission of the Controller of HMSO (c) Crown Copyright reserved.
Unauthorised reproduction infringes Crown copyright and may lead to prosecution or civil proceedings West Sussex County Council Licence No. 100023447